

Why THE MADISON SKATEPARK FUND?

Since 2000, MSF has:

- Gathered approximately 4,000 signatures from the Williamson/Marquette neighborhood in support of a skatepark.
- Gained the endorsement of the Mayor's office.
- Developed real and lasting relationships with the community through activism and volunteer work in the Williamson/Marquette Neighborhood.
- Reconstructed the Lussier Teen Center's outdoor ramp.
- * Helped with the design and construction process for the skatepark at the new Goodman/Atwood Community Center.
- Petitioned, was recognized, and then appointed to be the primary planning agency and fund-raising organization for this exciting project by the Madison Parks Commission.
- Secured a fiscal agent partnership with the Madison Parks Foundation.
- Maintained an active presence at the recent Central Park Design and Implementation Task Force meetings.



"I support the idea of a free public skatepark in the City of Madison, and recognize the Madison Skatepark Fund as the main fund raising group to see that this project is completed. I look forward to working with them on this exciting endeavor."

Dave Cieslewicz
Mayor, City of Madison

What's THE NEXT STEP?

- Expand our network of resources through the Parks Foundation and further develop contacts with community groups and leaders.
- Secure an initial major donor.
- Use that momentum to pursue corporate and community foundation grants
- As we near our fundraising goal we plan to increase community buy-in with a "buy a brick" or similar fundraising campaign.
- As construction nears we will contact local companies for in-kind donations of goods and services.
- Establish an endowment for maintenance into the future.

How CAN I HELP?

- Donate fundraising time and/or ideas.
- Donate building materials and/or labor.
- Donate money. If you or your company is interested in contributing to this exciting project or if you would like to find out more, please email: madisonskatepark@gmail.com or visit our Web site at www.madisonskatepark.com

THANKS!



2825 University Ave. Madison, WI 53705
www.madisonskatepark.com



if madison
**DOESN'T HAVE
A SKATEPARK,**
then madison
IS A SKATEPARK.

Why A SKATEPARK?

- Skateboarding has continued to increase in popularity since its inception in the 1970s.
- There are approximately 15 million skateboarders in the United States today.
- The number of skateboarders has actually surpassed the number of baseball players (10.9 million) making it the third most popular sport in the United States.
- National surveys report that there are an estimated 50-100 users at any skatepark at any given time.

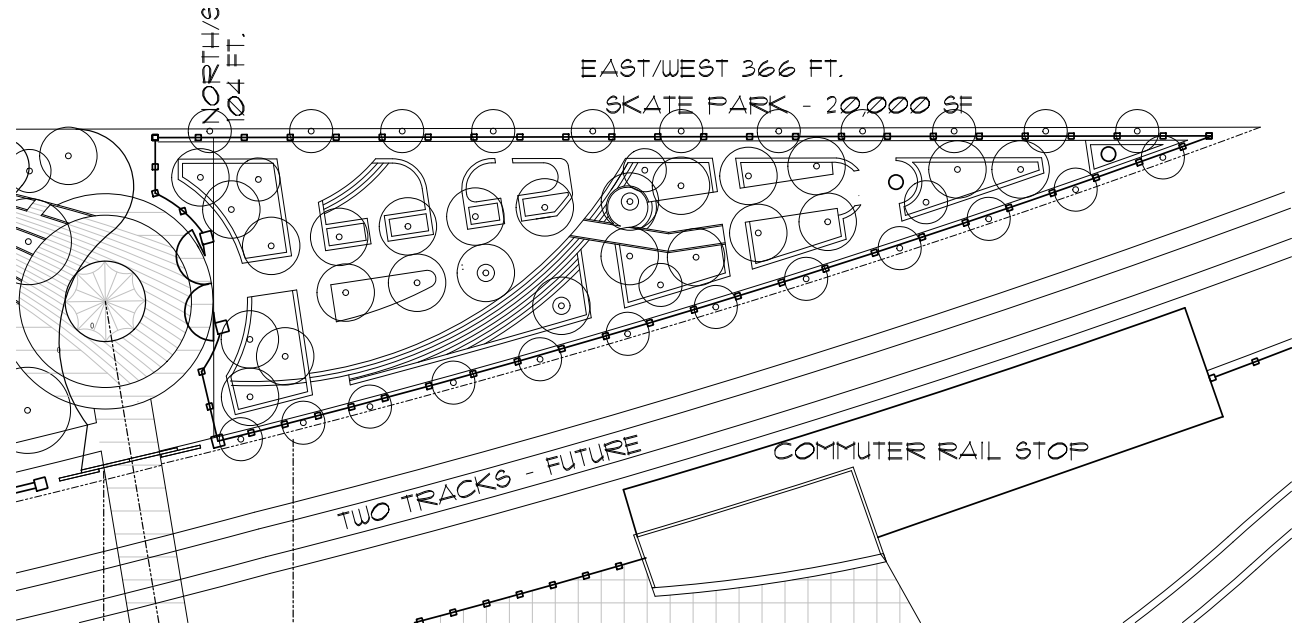

* This is NOT our final design...just an example of what we're thinking

Why MADISON? Why CENTRAL PARK?

- Currently, the only legal place to ride a skateboard in Madison is on a sidewalk in a residential area.
- A central location will provide easy access from all parts of the city.
- Mount Horeb, Stoughton, Sun Prairie, Verona, Waunakee, Lake Delton, LaCrosse, and Middleton all have skateparks.

What's OUR PLAN?

- A plaza style with a pool area (concrete).
- Appropriate for skaters of all skill levels, styles, and ages
- The plaza section is an artificial street course and will comprise approximately 75% of the total rideable square footage in the park.
- The pool section will have gentle transitions that range from three to eight feet in depth.

What ABOUT COST?

- Construction will cost approximately \$750,000.
- Creation of endowment for upkeep of the park is planned.



"MSF has shown a commitment to the community through its volunteer efforts for the Wilmar Neighborhood Center. A skatepark would be a colorful and valuable addition to the Williamson Marquette Neighborhood and the City of Madison."

Gary Kallas
Director, Wilmar Neighborhood Center



"MSF planned and furnished the labor to rebuild our dilapidated skateboard ramp at the Lussier Teen Center. The ramp now is used daily by skaters who visit just to ride the ramp. I do support the MSF's goal."

Howard Hayes:
Coordinator,
Goodman Atwood Community Center



"It's long overdue for our city to have a skatepark, and its placement in the Central Park is perfect. Judging from the petitions signed by over 4,000 neighborhood and city residents, MSF has the community's support. They certainly have mine."

Marsha Rummel
District 6 Alderperson, City of Madison